

3-Piece Ball Valves

BH Series

Features

- ⦿ Working pressure up to: 3000 psig (207 bar)
- ⦿ Working temperature: -20°F to 450°F (-28°C to 232°C)
- ⦿ End connections:
 - 1/8 to 2 thread
 - 1/8" to 2" pipe butt or socket weld
 - 1/4" to 2" and 6 mm to 50 mm tube butt or socket weld
 - 1/4" to 2" and 6 mm to 38 mm tube fitting
- ⦿ 3-piece precision cast body construction
- ⦿ Orifice sizes: 0.19" (4.8 mm) to 1.5" (38.1 mm)
- ⦿ Blowout proof stem
- ⦿ Pneumatic and electric actuator available
- ⦿ Bidirectional flow for 2-way valves
- ⦿ Bottom port as inlet for 3-way valves
- ⦿ Leak-tight performance testing with nitrogen or compressed air for every valve at the rated pressure to meet the requirement of no visible leak

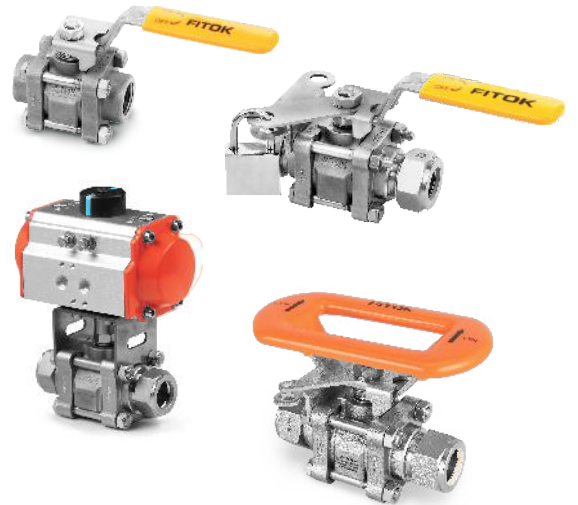

Pressure vs. Temperature

2-way Valves

Orifice Size: 0.19", 0.28", 0.41", 0.52" & 0.88"

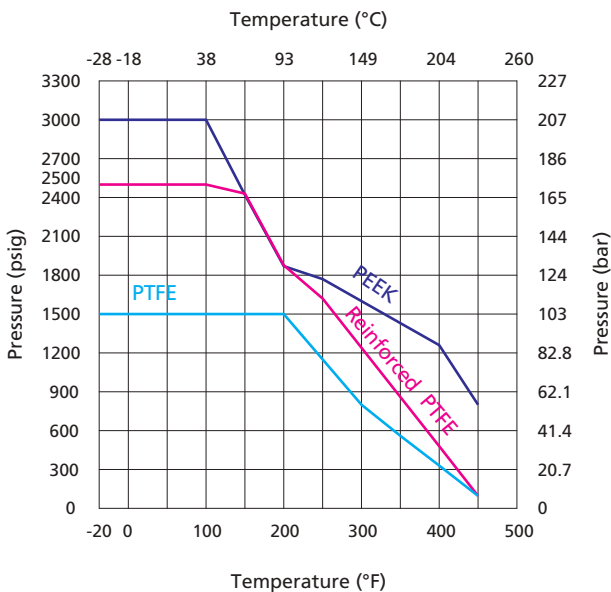

Orifice Size: 1.13", 1.25" & 1.50"

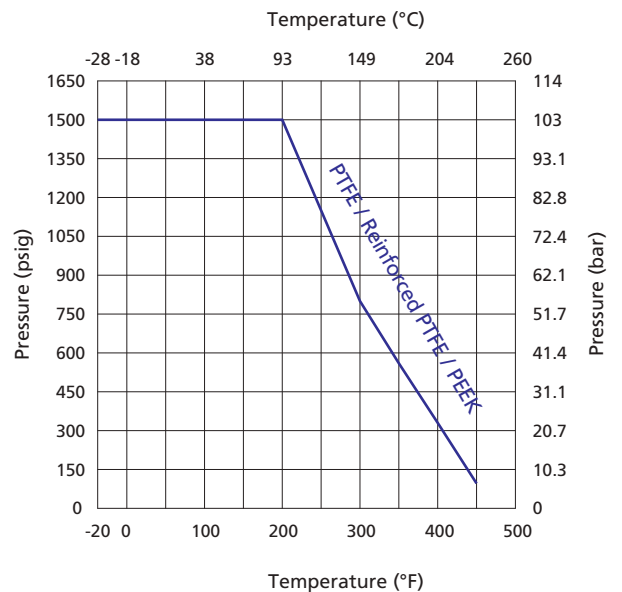

3-way Valves

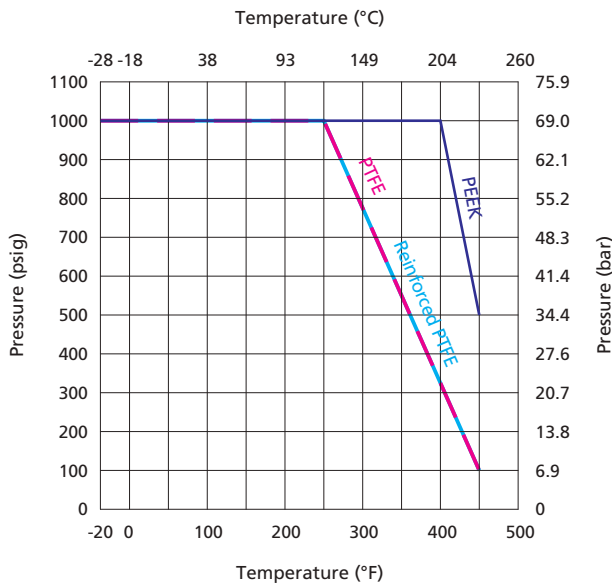

Note: The temperature and pressure rating are based on valves of standard materials.

Standard Materials of Construction

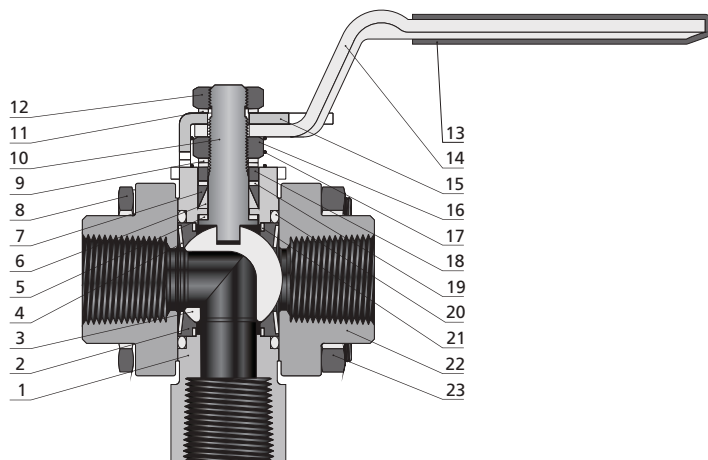
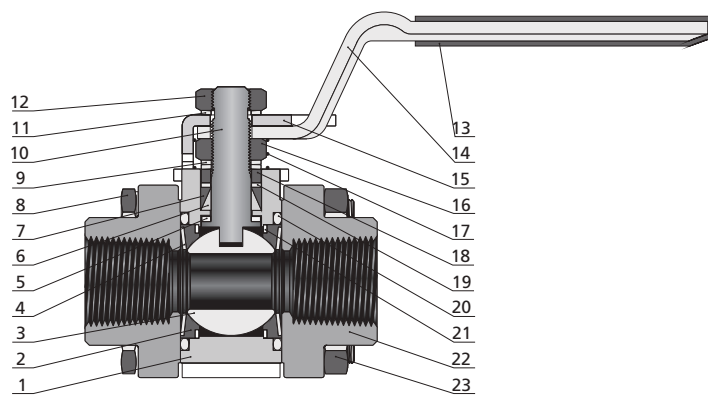

| Item | Component | Material Grade/ASME Specification | |
|-------------------|--------------------------|--|-----------------|
| 1 | <i>Body</i> | <i>CF8M/A351</i> | <i>CF8/A351</i> |
| 2 | <i>Seat</i> | <i>PTFE or Reinforced PTFE or PEEK</i> | |
| 3 | <i>Ball</i> | <i>316 SS/A479</i> | |
| 4 | <i>Coned-disc Spring</i> | <i>Strain-hardened 316 SS/A240</i> | |
| 5 | <i>Stem Bearing</i> | <i>PEEK</i> | |
| 6 | <i>Lower Packing</i> | <i>Reinforced PTFE</i> | |
| 7 | <i>Upper Packing</i> | <i>Reinforced PTFE</i> | |
| 8 | Body Bolt | Gr. B8M/A193 | |
| 9 | Stem Spring | Strain-hardened 316 SS/A240 | |
| 10 | <i>Stem</i> | <i>316 SS/A479</i> | |
| 11 | Stem Spring | Strain-hardened 316 SS/A240 | |
| 12 | Stem Nut | Gr. 8M/A194 | |
| 13 | Handle Sleeve | Vinyl | |
| 14 | Handle | 304 SS/A240 | |
| 15 | Stop Plate | 304 SS/A240 | |
| 16 | Stem Nut | Gr. 8M/A194 | |
| 17 | Grounding Spring | 302 SS/A313 | |
| 18 | Gland | PTFE-coated 316 SS/A479 | |
| 19 | <i>Packing Support</i> | <i>PEEK</i> | |
| 20 | <i>Flange Seal</i> | <i>PTFE/D1710</i> | |
| 21 | <i>Support Ring</i> | <i>316 SS/A240</i> | |
| 22 | <i>End Connection</i> | <i>CF8M/A351</i> | <i>CF8/A351</i> |
| 23 | Body Nut | Gr.8M/A194 | |
| <i>Lubricants</i> | | <i>Silicone-based and PTFE-based</i> | |

Note: Wetted components are listed in italics. For other materials, please contact FITOK Group or our authorized distributors.

Dimensions

2-way Valves

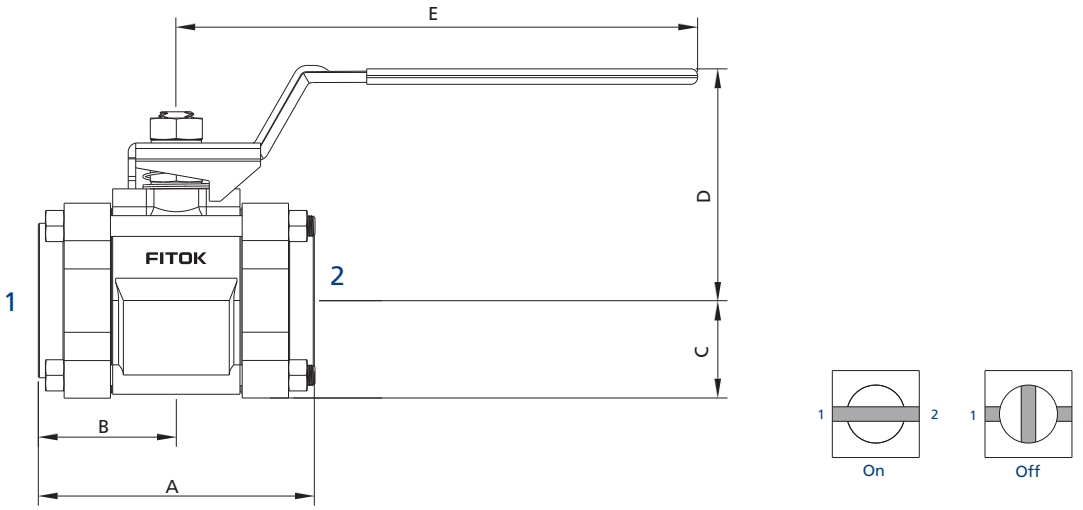

3-way Valves

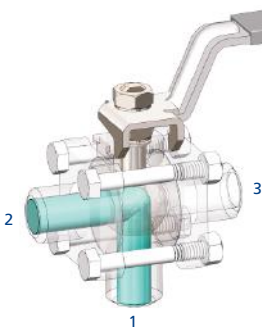
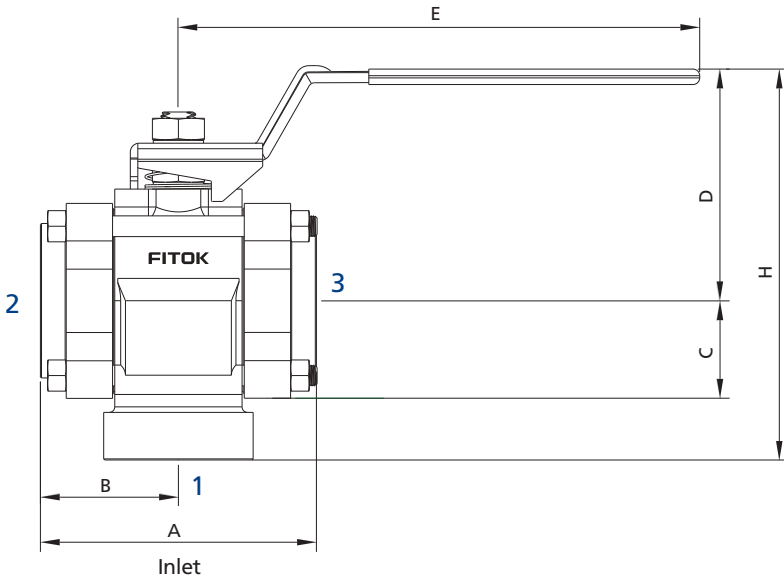

Port 1 to port 2

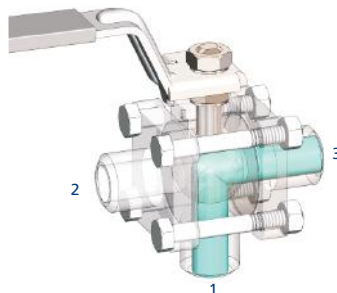

Port 1 to port 3

| Basic Ordering Number | | Connection Type and Size | | Orifice in. (mm) | | Cv | | Dimensions, in. (mm) | | | | | | | | | | | | | | |
|-----------------------|-----------------|--------------------------|--------------------------|------------------|----------------|-------|-------|----------------------|----------------|----------------|----------------|----------------|----------------|----------------|----------------|---|----------------|----------------|--------------|---|---|---------------|
| 2-way | 3-way | Connection 1 | Connection 2/3 | 2-way | 3-way | 2-way | 3-way | A | B | C | D | E | H | | | | | | | | | |
| BH□□-FL4-05 | BH□□-FL4-05-3 | 1/4" FITOK | 1/4" FITOK | 0.19 (4.8) | 0.19 (4.8) | 1.2 | 1.2 | 3.17 (80.5) | 1.59 (40.4) | 0.68 (17.3) | 1.66 (42.2) | 2.37 (60.2) | 3.35 (85.1) | | | | | | | | | |
| BH□□-ML6-05 | BH□□-ML6-05-3 | 6 mm FITOK | 6 mm FITOK | | | | | | | | | | | | | | | | | | | |
| BH□□-ML8-05 | BH□□-ML8-05-3 | 8 mm FITOK | 8 mm FITOK | | | | | | | | | | | | | | | | | | | |
| BH□□-TS4-05 | — | 1/4" TS | 1/4" TS | | — | 1.2 | — | 2.16 (54.9) | 1.08 (27.4) | — | — | — | | | | | | | | | | |
| BH□□-MTS6-05 | — | 6 mm Tube Socket Weld | 6 mm Tube Socket Weld | | | | | | | | | | | | | | | | | | | |
| BH□□-PB4-05 | — | 1/4×SCH80 Pipe Butt Weld | 1/4×SCH80 Pipe Butt Weld | | | | | | | | | | | | | | | | | | | |
| BH□□-FNS2-07 | BH□□-FNS2-07-3 | 1/8 Female NPT | 1/8 Female NPT | 0.28 (7.1) | 0.28 (7.1) | 3.8 | 1.7 | 2.16 (54.9) | 1.08 (27.4) | 0.68 (17.3) | 1.66 (42.2) | 2.37 (60.2) | 3.12 (79.2) | | | | | | | | | |
| BH□□-FRT2-07 | BH□□-FRT2-07-3 | 1/8 Female BSPT | 1/8 Female BSPT | | | | | | | | | | | | | | | | | | | |
| BH□□-FRP2-07 | BH□□-FRP2-07-3 | 1/8 Female BSPP | 1/8 Female BSPP | | | | | | | | | | | | | | | | | | | |
| BH□□-FNS4-07 | BH□□-FNS4-07-3 | 1/4 Female NPT | 1/4 Female NPT | | | | | | | | | | | | | | | | | | | |
| BH□□-FRT4-07 | BH□□-FRT4-07-3 | 1/4 Female BSPT | 1/4 Female BSPT | | | | | | | | | | | | | | | | | | | |
| BH□□-FRP4-07 | BH□□-FRP4-07-3 | 1/4 Female BSPP | 1/4 Female BSPP | | | | | | | | | | | | | | | | | | | |
| BH□□-FL6-07 | BH□□-FL6-07-3 | 3/8" FITOK | 3/8" FITOK | | | | | | | | | | | 3.17 (80.5) | 1.59 (40.4) | — | — | — | — | — | — | 4.37 (111) |
| BH□□-ML10-07 | BH□□-ML10-07-3 | 10 mm FITOK | 10 mm FITOK | | | | | | | | | | | | | | | | | | | |
| BH□□-TS6-07 | — | 3/8" TS | 3/8" TS | | | | | | | | | | | — | — | — | 2.16 (54.9) | 1.08 (27.4) | — | — | — | — |
| BH□□-PB6-07 | — | 3/8×SCH80 Pipe Butt Weld | 3/8×SCH80 Pipe Butt Weld | | | | | | | | | | | | | | | | | | | |
| BH□□-FL8-10 | BH□□-FL8-10-3 | 1/2" FITOK | 1/2" FITOK | 0.41 (10.4) | 0.41 (10.4) | 7.5 | 3.5 | 4.04 (103) | 2.02 (51.3) | 0.89 (22.6) | 2.35 (59.7) | 4.50 (114) | 4.48 (114) | | | | | | | | | |
| BH□□-ML12-10 | BH□□-ML12-10-3 | 12 mm FITOK | 12 mm FITOK | | | | | | | | | | | | | | | | | | | |
| BH□□-TS8-10 | — | 1/2" TS | 1/2" TS | | | | | | | | | | | | | | | | | | | |
| BH□□-FNS6-13 | BH□□-FNS6-13-3 | 3/8 Female NPT | 3/8 Female NPT | 0.52 (13.1) | 0.52 (13.1) | 12.0 | 5.0 | 2.70 (68.6) | 1.35 (34.3) | — | — | — | 4.19 (106) | | | | | | | | | |
| BH□□-FRT6-13 | BH□□-FRT6-13-3 | 3/8 Female BSPT | 3/8 Female BSPT | | | | | | | | | | | | | | | | | | | |
| BH□□-FRP6-13 | BH□□-FRP6-13-3 | 3/8 Female BSPP | 3/8 Female BSPP | | | | | | | | | | | | | | | | | | | |
| BH□□-FNS8-13 | BH□□-FNS8-13-3 | 1/2 Female NPT | 1/2 Female NPT | | | | | | | | | | | | | | | | | | | |
| BH□□-FRT8-13 | BH□□-FRT8-13-3 | 1/2 Female BSPT | 1/2 Female BSPT | | | | | | | | | | | | | | | | | | | |
| BH□□-FRP8-13 | BH□□-FRP8-13-3 | 1/2 Female BSPP | 1/2 Female BSPP | | | | | | | | | | | | | | | | | | | |
| BH□□-FL12-13 | BH□□-FL12-13-3 | 3/4" FITOK | 3/4" FITOK | | | | | | | | | | | 4.04 (103) | 2.02 (51.3) | — | — | — | — | — | — | 4.48 (114) |
| BH□□-ML16-13 | BH□□-ML16-13-3 | 16 mm FITOK | 16 mm FITOK | | | | | | | | | | | | | | | | | | | |
| BH□□-ML18-13 | BH□□-ML18-13-3 | 18 mm FITOK | 18 mm FITOK | | | | | | | | | | | — | — | — | 15.0 | 2.70 (68.6) | 1.34 (34) | — | — | — |
| BH□□-TS12-13 | — | 3/4" TS | 3/4" TS | | | | | | | | | | | | | | | | | | | |
| BH□□-PS8-13 | — | 1/2 PS | 1/2 PS | | | | | | | | | | | | | | | | | | | |
| BH□□-PB8-13 | — | 1/2×SCH80 Pipe Butt Weld | 1/2×SCH80 Pipe Butt Weld | — | — | 6.8 | 13.6 | 2.69 (68.3) | 1.34 (34) | — | — | — | | | | | | | | | | |
| BH□□-PB12-13 | — | 3/4×SCH80 Pipe Butt Weld | 3/4×SCH80 Pipe Butt Weld | | | | | | | | | | | | | | | | | | | |
| BH□□-FNS12-22 | BH□□-FNS12-22-3 | 3/4 Female NPT | 3/4 Female NPT | 0.88 (22.2) | 0.71 (18.0) | 31.0 | 12.0 | 3.59 (91.2) | 1.8 (45.7) | 1.25 (31.8) | 2.94 (74.7) | 6.00 (152) | 5.45 (138) | | | | | | | | | |
| BH□□-FRT12-22 | BH□□-FRT12-22-3 | 3/4 Female BSPT | 3/4 Female BSPT | | | | | | | | | | | | | | | | | | | |

B-20 Ball Valves

| Basic Ordering Number | | Connection Type and Size | | Orifice in.(mm) | | Cv | | Dimensions, in. (mm) | | | | | | | | | | | | | | | | | | | | |
|-----------------------|-----------------|----------------------------|----------------------------|-----------------|----------------|-------|-------|----------------------|----------------|----------------|----------------|---------------|---------------|------|------|----------------|----------------|----------------|---------------|---------------|---------------|---|---|---------------|----------------|----------------|---------------|---------------|
| 2-way | 3-way | Connection 1 | Connection 2/3 | 2-way | 3-way | 2-way | 3-way | A | B | C | D | E | H | | | | | | | | | | | | | | | |
| BH□□-FRP12-22 | BH□□-FRP12-22-3 | 3/4 Female BSPP | 3/4 Female BSPP | 0.71 (18.0) | 0.88 (22.2) | 31.0 | 12.0 | 3.59 (91.2) | 1.8 (45.7) | 1.25 (31.8) | 2.94 (74.7) | 6.00 (152) | 5.45 (138) | | | | | | | | | | | | | | | |
| BH□□-FNS16-22 | BH□□-FNS16-22-3 | 1 Female NPT | 1 Female NPT | | | | | 4.45 (113) | 2.23 (56.6) | | | | | | | | | | | | | | | | | | | |
| BH□□-FRT16-22 | BH□□-FRT16-22-3 | 1 Female BSPT | 1 Female BSPT | | | | | 5.36 (136) | 2.68 (68) | | | | | | | | | | | | | | | | | | | |
| BH□□-FRP16-22 | BH□□-FRP16-22-3 | 1 Female BSPP | 1 Female BSPP | | | | | 6.34 (161) | 3.17 (80.5) | | | | | | | | | | | | | | | | | | | |
| BH□□-FL16-22 | BH□□-FL16-22-3 | 1" FITOK | 1" FITOK | | | | | 5.36 (136) | 2.68 (68) | | | | | | | | | | | | | | | | | | | |
| BH□□-FL20-22 | BH□□-FL20-22-3 | 1 1/4" FITOK | 1 1/4" FITOK | | | | | 6.14 (156) | 3.07 (78) | | | | | | | | | | | | | | | | | | | |
| BH□□-ML25-22 | BH□□-ML25-22-3 | 25 mm FITOK | 25 mm FITOK | | | | | 3.59 (91.2) | 1.80 (45.7) | | | | | | | | | | | | | | | | | | | |
| BH□□-ML28-22 | BH□□-ML28-22-3 | 28 mm FITOK | 28 mm FITOK | | | | | 3.59 (91.2) | 1.80 (45.7) | | | | | | | | | | | | | | | | | | | |
| BH□□-TS16-22 | — | 1" TS | 1" TS | | | | | 3.59 (91.2) | 1.80 (45.7) | | | | | | | | | | | | | | | | | | | |
| BH□□-MTS25-22 | — | 25 mm Tube Socket Weld | 25 mm Tube Socket Weld | | | | | 3.59 (91.2) | 1.80 (45.7) | | | | | | | | | | | | | | | | | | | |
| BH□□-PS12-22 | — | 3/4 PS | 3/4 PS | 1.13 (28.6) | 0.87 (22.0) | 36.0 | 18.0 | 3.59 (91.2) | 1.80 (45.7) | 1.53 (38.9) | 4.03 (102) | 9.14 (232) | 6.86 (174) | | | | | | | | | | | | | | | |
| BH□□-PS16-22 | — | 1 PS | 1 PS | | | | | 4.39 (112) | 2.19 (55.6) | | | | | | | | | | | | | | | | | | | |
| BH□□-PB16-22 | — | 1xSCH80 Pipe Butt Weld | 1xSCH80 Pipe Butt Weld | | | | | 4.57 (116) | 2.28 (57.9) | | | | | | | | | | | | | | | | | | | |
| BH□□-TS20-29 | — | 1 1/4" TS | 1 1/4" TS | | | | | 4.51 (115) | 2.25 (57.2) | | | | | | | | | | | | | | | | | | | |
| BH□□-PB20-32 | — | 1 1/4xSCH80 Pipe Butt Weld | 1 1/4xSCH80 Pipe Butt Weld | | | | | 4.57 (116) | 2.28 (57.9) | | | | | | | | | | | | | | | | | | | |
| BH□□-FNS20-32 | BH□□-FNS20-32-3 | 1 1/4 Female NPT | 1 1/4 Female NPT | | | | | 1.25 (31.8) | 0.98 (25.0) | | | | | 90.0 | 23.0 | 4.39 (112) | 2.19 (55.6) | 1.74 (44.2) | 4.16 (106) | 9.14 (232) | 7.21 (183) | | | | | | | |
| BH□□-FNS24-32 | BH□□-FNS24-32-3 | 1 1/2 Female NPT | 1 1/2 Female NPT | | | | | | | | | | | | | 4.94 (125) | 2.47 (62.5) | | | | | | | | | | | |
| BH□□-TS24-32 | — | 1 1/2" TS | 1 1/2" TS | | | | | | | | | | | | | 6.14 (156) | 3.12 (78) | | | | | | | | | | | |
| BH□□-PS20-32 | — | 1 1/4 PS | 1 1/4 PS | | | | | | | | | | | | | 1.50 (38.1) | 130.0 | | | | | — | — | 4.94 (125) | 2.47 (62.5) | 1.74 (44.2) | 4.16 (106) | 9.14 (232) |
| BH□□-PS24-32 | — | 1 1/2 PS | 1 1/2 PS | | | | | | | | | | | | | | | | | | | | | | | | | |
| BH□□-PB24-32 | — | 1 1/2xSCH80 Pipe Butt Weld | 1 1/2xSCH80 Pipe Butt Weld | | | | | | | | | | | | | | | | | | | | | | | | | |
| BH□□-FNS32-38 | BH□□-FNS32-38-3 | 2 Female NPT | 2 Female NPT | | | | | | | | | | | | | | | | | | | | | | | | | |
| BH□□-FRT32-38 | BH□□-FRT32-38-3 | 2 Female BSPT | 2 Female BSPT | | | | | | | | | | | | | | | | | | | | | | | | | |
| BH□□-TS32-38 | — | 2" TS | 2" TS | | | | | | | | | | | | | | | | | | | | | | | | | |
| BH□□-PS32-38 | — | 2 PS | 2 PS | | | | | | | | | | | | | | | | | | | | | | | | | |
| BH□□-PB32-38 | — | 2xSCH80 Pipe Butt Weld | 2xSCH80 Pipe Butt Weld | | | | | | | | | | | | | | | | | | | | | | | | | |

1. FITOK means FITOK double ferrule tube fittings, TS means fractional tube socket weld, MTS means metric tube socket weld, TB means fractional tube butt weld, MTB means metric tube butt weld, PS means pipe socket weld, and PB means pipe butt weld.
2. Sizes and types listed are standard. Other sizes and types are available upon request, please contact FITOK Group or our authorized distributors.
3. Dimensions are shown with tube fitting nuts finger-tightened. All dimensions are for reference only and are subject to change. For dimensions not shown above, please contact FITOK Group or our authorized distributors.

Ball Valves for Special Applications

Fire safe applications

API 607 and ISO 15848-1 certified.
 Patented stem packing design and seat design.
 Working temperature: -40°F to 400°F (-40°C to 204°C).
 Working pressure up to: 1500 psig (103 bar).
 Orifice size: 0.19" (4.8 mm) to 1.25" (31.8 mm).
 Helium leak rate/stem diameter $\leq 1.78 \times 10^{-6}$ std cm³/s.
 To order a fire safe valve, add -IE to the valve ordering number.
 For example: BHSS-FL16-22-IE
 To order a FDA-compliant fire safe valve, add -FDA-IE to the valve ordering number.
 For example: BHSS-FL16-22-FDA-IE



Structure Features

Live-loaded disc spring

Elastic compensation effect

Graphite stem packing

Maintain good sealing performance under fire conditions

PTFE stem packing

Maintain good sealing performance under normal conditions

Metal seal design

Reduce the risk of leakage under fire conditions by reducing the active gap between the spherical surface and the sealing surface

PTFE flange seal

Maintain good sealing performance under normal conditions

PTFE seat

Maintain good sealing performance under normal conditions

Graphite flange seal

Maintain good sealing performance under fire conditions

Anti-static device

Grounding spring to provide anti-static protection

Special bolt construction

Maintain body seal during rapid temperature changes resulting from fire exposure and water quenching

Vented ball

Allow pressure to equalize between the valve body and the upstream port, preventing overpressurization and potential seal blowout under fire conditions

Pressure vs. Temperature

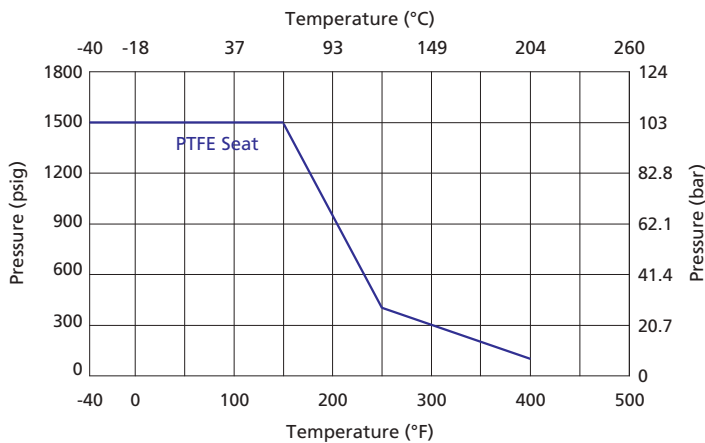

Standard Materials of Construction

| Component | Material/ ASME Specification |
|---------------------------|---------------------------------|
| <i>Disc Spring</i> | <i>Alloy X-750/AMS 5542</i> |
| Flange Seal | Graphite |
| Stem Packing | Graphite |
| <i>Packing Support</i> | <i>316 SS/A479</i> |
| <i>Stem Lower Bearing</i> | <i>316 SS/A479</i> |
| <i>Stem Upper Bearing</i> | <i>PEEK</i> |
| Body Bolt | SS |

Notes: Wetted components are listed in italics. Other components not listed are in the same material as components of general service ball valves. For other materials, please contact FITOK Group or our authorized distributors.

Seal Kits

| Valve Orifice | Flow Pattern | Basic Seal Kit Ordering Number | Content |
|---------------|--------------|--------------------------------|---|
| 05/07 | 2-way | BHSS-□4-RK | Seat, coned-disc spring, stem bearing, lower packing, upper packing, stem spring, gland, packing support, flange seal, instructions |
| | 3-way | | |
| 10/13 | 2-way | BHSS-□8-RK | |
| | 3-way | | |
| 22 | 2-way | BHSS-□16-RK | |
| | 3-way | | |
| 29/32 | 2-way | BHSS-□24-RK | |
| | 3-way | | |
| 38 | 2-way | BHSS-□32-RK | |
| | 3-way | | |

| Seat Material | Designator |
|-----------------|------------|
| PTFE | - |
| Reinforced PTFE | R |
| PEEK | P |

- Seal kit components are the same materials and grades listed in materials of construction.
- The default seat material in the seal kit for BH series valves is PTFE. To order seats with other materials, add a seat material designator to "□" in the basic seal kit ordering number to get a complete ordering number.
Example: BHSS-8-RK
BHSS-P8-RK
- The listed basic seal kit ordering numbers specify CF8M material. To order kits with other materials, such as CF8, replace "SS" with "S4" in the ordering number.
Example: BHS4-8-RK

Locking Device

- ⊙ Lock BH series 2-way or 3-way valves, locking hole diameters of the whole series of valves are 0.20 in (5.0 mm).
- ⊙ To order a ball valve with locking device, add -L to the valve ordering number.
Example: BHSS-FL16-22-L/BHSS-FL16-22-3L

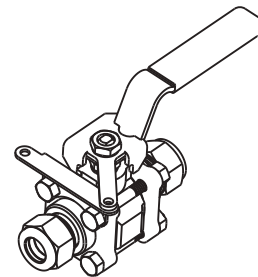

Ball Valve without Handle

- ⊙ Ball Valve without handle can be directly connected to the FITOK actuator assembly.
- ⊙ To order, please add -AM to the valve ordering number.
Example: BHSS-FL4-P05-AM

Ordering Number Description

BHS4 - FNS8 - FRT8 - FL8 - P13G - OHQ3L - SCEF2

| Series | Body Material | Connection 1 Type | Connection 1 Size | Connection 2/3 Type | Connection 2/3 Size | Seat Material | Orifice Size | Packing Material | Handle/Actuator | For Actuator | Flow Pattern | Locking Device | Special Application | Cleaning and Packaging |
|--------|-------------------------|---|--|---|---------------------|-------------------|--------------------|------------------|--|---|--------------|----------------|---|------------------------|
| BH | SS S4 CF8M CF8 | FNS Female NPT | 2 1/8" | Same as Connection 1 | | PTFE | 05 0.19" (4.8 mm) | Reinforced PTFE | I Yellow Handle Sleeve | | None | No | None | FC-01 |
| | | NS Male NPT | 4 1/4" or 1/4xSCH80 | Specified in the same way as Connection 1 type and size | | R Reinforced PTFE | 07 0.28" (7.1 mm) | G Graphite | GR Green Handle Sleeve | H Mechanical Limit Switch | | L Yes | S NACE MR0175 | F2 FC-02 |
| | | FRT Female BSPT | 5 5/16" | | | P PEEK | 10 0.41" (10.4 mm) | | J Blue Handle Sleeve | N Inductive Limit Switch | | | SI SilcoNert® 2000 (Sulfinert®) Coating | |
| | | RT Male BSPT | 6 3/8" or 6 mm or 3/8xSCH80 | | | | 13 0.52" (13.1 mm) | | EL Oval Handle with Orange Sleeve | Q Solenoid Valve | | | CE CE Certification | |
| | | FRP Female BSPP (for RP) | 8 1/2" or 8 mm or 1/2xSCH80 | | | | 22 0.88" (22.2 mm) | | AM Without Handle | HQ Mechanical Limit Switch and Solenoid Valve | | | | |
| | | BP Male BSPP (for RG) | 10 10 mm | | | | 29 1.13" (28.6 mm) | | C 90° Normally Closed Pneumatic Actuator | NQ Inductive Limit Switch and Solenoid Valve | | | | |
| | | FMS Female Metric Thread (for RG-M) | 12 3/4" or 12 mm or 3/4xSCH80 | | | | 32 1.25" (31.8 mm) | | O 90° Normally Open Pneumatic Actuator | | | | | |
| | | MS Male Metric Thread (for RG-M) | 14 14 mm or M14x1.5 | | | | 38 1.50" (38.1 mm) | | D 90° Double Acting Pneumatic Actuator | | | | | |
| | | MTS Metric Tube Socket | 16 1" or 16 mm or 1xSCH80 | | | | | | LX 180° Left End Normally Open Pneumatic Actuator | | | | | |
| | | TS Fractional Tube Socket | 18 18 mm | | | | | | RX 180° Right End Normally Open Pneumatic Actuator | | | | | |
| | | MTB Metric Tube Butt Weld | 20 1 1/4" or 20 mm or M20x1.5 or 1 1/4xSCH80 | | | | | | DX 180° Double Acting Pneumatic Actuator | | | | | |
| | | TB Fractional Tube Butt Weld | 22 22 mm or M22x1.5 | | | | | | E 90° Electric Actuator | | | | | |
| | | PS Pipe Socket Weld | 24 1 1/2" or M24x1.5 or 1-1/2xSCH80 | | | | | | EX 180° Electric Actuator | | | | | |
| | | PB Pipe Butt Weld | 25 25 mm | | | | | | | | | | | |
| | | FL Fractional Tube Fitting | 27 M27x2 | | | | | | | | | | | |
| | | ML Metric Tube Fitting | 28 28 mm | | | | | | | | | | | |
| | | UFB Rotatable Fractional Tube Butt Weld | 32 2" or 2xSCH80 | | | | | | | | | | | |
| | | UMB Rotatable Metric Tube Butt Weld | | | | | | | | | | | | |
| | | UPB Nut + Gasket + Pipe Bulged Nipple | | | | | | | | | | | | |
| | | FO Male FO Fitting | | | | | | | | | | | | |
| | | FR Male FR Fitting | | | | | | | | | | | | |

- Standard thread pitch for metric threads are as follows:
M10 and below: 1 mm
M12 to M24: 1.5 mm
M27 and above: 2 mm
Standard thread pitch should be omitted in the ordering number, others should be specified.
- If you need a port with orbital welding, please contact FITOK Group.
- FO means FITOK O-ring face seal fittings.
FR means FITOK metal gasket face seal fittings.
- For oxygen-enriched environment or hazardous media service, contact FITOK Group or our authorized distributors.
- Cleaning and Packaging:
FC-01: Standard cleaning and packaging for general industrial procedures.
FC-02: Special cleaning and packaging for wetted system components to ensure compliance with product cleanliness requirements of ASTM G93 Level C.

Note: "Ordering Number Description" is a reference to understand the combination rules of FITOK product part number. Not all combinations are available.

- For more information about pneumatic actuator ball valves, please refer to the catalog Actuated Ball Valves.
- SilcoNert® 2000 (Sulfinert®) Coating: Except for ball valves with PEEK seat, wetted metal components SilcoNert® 2000 (Sulfinert®) coated.
- CE certification is available. For more information, please contact FITOK group or our authorized distributors